



The 2023 Summer Research Poster Session

ROSALIND FRANKLIN UNIVERSITY *of* MEDICINE AND SCIENCE



Program

Monday, December 11th, 2023

Opening Remarks

3:30 PM

Dr. Robert A. Marr

Judging

3:30 PM – 5:30 PM

Presentation of Awards

5:30 PM – 5:45 PM

Dr. William M. Scholl

College of Podiatric Medicine

Dr. Noah Rosenblatt, Associate Dean of Research

College of Pharmacy

Dr. Ateequr Rahman, Director of Research

Chicago Medical School

Dr. Robert A. Marr, Assistant Dean of Research

We would like to thank our judges, mentors, schools, and the university as a whole for supporting our endeavor to learn through research.

Without all your assistance, none of this would be possible.

Scholl College of Podiatric Medicine

Last Name	First Name	Poster Title	Mentor's Name(s)	Poster #
Arp	Jack	Preoperative Patient Expectations for Hallux Valgus Surgery	Dr. Adam Fleischer	11
Bhatt	Zalak	Effects of Bunion Surgery on Fall Risk: A Nationwide Database Study of 127,990 Older Adults with Hallux Valgus	Dr. Adam Fleischer, Dr. Rachel Albright	1
Cao	Ceclina	Reducing Ground Reaction Forces with Visual Feedback of Tibial Acceleration During Walking	Dr. Sai Yalla	5
Cook	Brittany	Impact of Various Flooring Surfaces on Foot Loading and Gait	Dr. Ryan Crews	8
Cruse	Ellie	Attentional Demands of the Coordination of Foot Placement During Gait	Dr. Noah Rosenblatt, Dr. Marco Avalos	4
Daji	Aayushi	Impact of Unilateral Amputations and Lower Limb Prosthesis on the Functions of Intact Foot	Dr. Noah J. Rosenblatt PhD, Dr. Sydney Yau DPM	14
Edwar Labib	Merna	Amputation during and after covid	Dr. Alana Wahl	6
Hattendorf	Kyler	The Reliability of Thermal Imaging in the Assessment of Microvascular Circulation: FLIR Thermal Imaging versus Skin Perfusion Pressure	Dr. Lauren Schnack, Dr. Leland Jaffe	7
Kaur	Manpreet	Inflammatory Phenotypes of Cerebral Perivascular Macrophages from Lean and Obese Mice	Dr. Carl White, PhD	13
Mitchell	Lauren	Socio-structural factors impacting ability for type 2 diabetics in LCHD care to achieve all 6 standards of care	Dr. Amanda Simanek	9
Shaitrit	Maya	Congruence Between Diabetic Wound Patients' Nutritional Literacy and Provider Expectations: A Research Study	Dr. Leland Jaffe	12
Sharifi	Tarlan	The effect of provider-type on fall risk in older adults with foot pain and disability	Dr. Adam Fleischer	2
Smith	Meagan	Characterization of Brain Perivascular Macrophages in Lean Versus Obese Mice	Dr. Carl White	10
Thokkudubiyapu	Monica	Location of Subsensory Vibration and its Effects on Proprioception, Balance, and Gait in Diabetic Peripheral Neuropathy Population	Dr. Sai Yalla	3
Ye	Andy	Forward Genetic Screening to Identify Novel Regulators of CaV2/UNC-2 Channel Levels	Dr. Hongkyun Kim, PhD	15

Posters

College of Pharmacy

<i>Last Name</i>	<i>First Name</i>	<i>Poster Title</i>	<i>Mentor's Name(s)</i>	<i>Poster #</i>
Alwan	Aya	Burn Injury Patterns in Emergency Department Visits	Dr. Ateequr Rahman	16
Akinsanya	Tobi	IER3 paucity inhibits oxLDL-induced Foam Cell Formation in ApoE-deficient macrophages via promoting an alternative phenotype	Dr. Mohd Shahid	18
Cocroft	Davontae	Anti-inflammatory Macrophages Attenuate Atherosclerotic Foam Cell Formation	Dr. Mohd Shahid	19
Guzek	Alexandra	Characteristics of Adults Aged 18–64 Who Did Not Take Medication as Prescribed to Reduce Costs: United States, 2021	Dr. Rahul Deshmukh	21
Jahromi	Nadia	Obesity Patterns among Adolescents in the United States	Dr. Ateequr Rahman	22
Joseph	Joanna	Personal Continuous Glucose Monitors and Glycemic Control Through Pharmacist-assisted Interventions: An Interim Analysis	Dr. Danielle Candelario, Dr. Khyati Patel	17
Khosa	Joyjeet	Characteristics of Adults Aged 18–64 Who Did Not Take Medication as Prescribed to Reduce Costs: United States, 2021	Dr. Rahul Deshmukh	21
Preda	Tiffany	Characteristics of Adults Aged 18–64 Who Did Not Take Medication as Prescribed to Reduce Costs: United States, 2021	Dr. Rahul Deshmukh	21
Schmit	Gabriella	Emergency Department Visits for Alcohol-Related Incidents in the United States	Dr. Ateequr Rahman	20

Chicago Medical School

Last Name	First Name	Poster Title	Mentor's Name(s)	Poster #
Aamir	Aroosha	Trauma-Informed Care in OB/Gyn Practice	Dr. Pamela Scorza, PhD	59
Agnani	Abhinav	Correlation of Suicide Prevalence and Education Expenditure in American High Schools	Dr. Dennis Stevens	58
Alderson	Bryce	The use of ketamine for prehospital sedative-assisted intubation	Dr. Nathan Sandalow	54
Allen	Matthew	Patient Preference Project - Pituitary Adenoma Resection	Dr. Anand Germanwala	113
Arzuaga	Angelica	Live Well Lake County Access to Care Team: Development of a Health Literacy Community Conversation Guide	Dr. Yvette Castañeda and Dr. Amanda Simanek	85
Au	Nathan	Limitations of the Location-Based and Polyp-Based Resect and Discard Strategies	Dr. William Karnes	74
Bae	Gloria	Risk of PICC-Related Upper Extremity Deep Vein Thrombosis in Relation to Type of Surgical Procedure in Trauma Patients	Dr. Amy Stewart, MD, FACS, D-ABA	97
Banizs	Gregory	Effectiveness of Clonidine, Dexmedetomidine, and Fentanyl Adjuncts for Labor Epidural Analgesia	Dr. Grace Lim	26
Beasley	Sydney	Gliflozins in Cardiac Resuscitation	Dr. Raul Gazmuri	92
Bell	Kristina	An analysis of prominent birth outcomes by hispanic heritage	Dr. Dennis Stevens	53
Bieber	Rebecca	The Healing Power of Diaries in Alleviating Post-Traumatic Stress Disorder Among Pediatric Intensive Care Unit Parents - A Pilot Study	Dr. David Thoele & Dr. Amy Stewart	47
Bobrov	Sean	Design of a Novel Bioreactor to Assess the Relationship Between Proximal Tubule Path Length and Sodium Regulation	Dr. William Fissell, Dr. Kuniko Hunter	25
Bonner	Kari	OBGYN Unveiled: The Truth About PCOS on Social Media and the Current State of Residency Programs	Dr. Callie Cox-Bauer	40
Bruce	Elizabeth	Implications of Ruptured Ectopic Pregnancy Incidence since the Dobbs v Jackson Women's Health Organization Decision	Dr. Marie Forgie DO	104
Chandrasekaran	Adithya	Dying with Dignity or Dishonor? End of Life Care in the Intensive Care Unit	Dr. Anne Stey	112
Chen	Brian	The Use of Virtual Reality to Reduce Anxiety and Pain in Perioperative Settings	Dr. Sakura Kinjo	77
Chen	Angela	Assessing the Understanding of Perioperative Neurocognitive Disorders in Minority Elders with Non-English Language Preferences	Dr. Cecilia Canales	81
Chen	Jin	Traumatic Brain Injury, Concussion, Chronic Traumatic Encephalopathy: Level of Care Pathways & Treatment Strategies	Dr. Richardo Senno	45
Cherian	Zachary	Artificial Intelligence and Deep Learning Models in the Detection and Diagnosis of Cardiovascular Disease	Dr. Kenneth Dodd	102
Cho	Eric	Screening for Novel Autoantibodies in anti-Mi-2 and anti-Jo-1 Myositis Patients	Andrew L. Mammen MD PhD, Iago Pinal-Fernandez MD PhD PhD, Katherine Pak MD	70
Croce	Elizabeth	SUHI Gun Violence Research Collaborative	Dr. Myles Castro	38
D'Elia	Michael	Gliflozins for Cardiac Resuscitation	Dr. Raul Gazmuri, MD	92
Dahal	Amogha	Extracorporeal Membrane Oxygenation Support for Cardiogenic Shock Due to Severe Bioprosthetic Valve Aortic Stenosis	Dr. Nikhil Narang	36
Daniel	Travette	Cervical Disc Replacement Lowers Rate of Reoperation Compared to Anterior Cervical Discectomy Fusion	Dr. Adam Pearson, MD	117
Devine	Maura	Effects of Mindfulness-Based Stress Reduction on Blood Pressure Readings: A Systematic Review	Dr. Dennis Stevens	42

Chicago Medical School

Last Name	First Name	Poster Title	Mentor's Name(s)	Poster #
Dieter	Alayna	Gliflozins in Cardiac Resuscitation	Dr. Raul Gazmuri	92
Divecha	Chirag	Utilization of the ResNet18 Convolutional Neural Network for Computer Assisted Detection of Stress Fractures of the Ankle and Foot	Dr. Mark Conneely	80
Ehrlich	Lauren	Using Safer Dx Instrument as a Tool to Identify Diagnostic Error and Improve Patient Safety	Dr. Rachel Zastrow, DNP	28
El Hendy Gunnarsson	Adam	Examining Racial Disparities in Time to Imaging for COVID-19 Patients	Dr. Dennis Stevens	43
Fahey	Joseph	Artificial Intelligence Chatbot Performance in Diagnostic Accuracy and Triage Urgency for Simulated Ophthalmic Complaints	Dr. Rukhsana Mirza	98
Farkash	Abigail	Access to Maternity Care in Chicago- A Local Level Environmental Scan	Dr. Maureen Benjamins and Dr. Melissa Gutierrez-Kapheim	51
Galeczka	Erika	Evaluation of Continuous Skin Surface Temperature Monitoring and Temperature Transition Point Determination in Hemodynamically Unstable Patients	Dr. Raul Gazmuri	67
Galluccio	Sophia	Racial Inequities on Maternal Morbidity: A Study on Anemia and Substance Use Disorder	Rheiner Mbaezue MD, MPH, Fernanda Alvarado MD, Connie Moreland MD, MmSc, FACOG	37
Ghalehei	Melika	Clinical Validation of a Handheld Deep Learning Tool for Glaucoma Medication Identification	Dr. Ken Lin MD, PhD	95
Gijsbers	Nathalie	Transmagnetic Stimulation integrative therapy analysis and efficacy in decreasing Depression and Anxiety.	Dr. Laura Viner	79
Goldsmith	Campbell	Comparison of two methods of spine scanning in the assessment of posture	Dr. Patrick Knott	39
Gorski	Justin	The use of ketamine for prehospital sedative-assisted intubation	Dr. Nathan Sandalow	54
Gupta	Aayush	Emerging Nonsurgical Interventions for Chronic Lower Back Pain	Dr. Nick Knezevic	68
Haddad	Brenda	Focus Groups on Physical Activity in Transmasculine Youth	Dr. SumanasJordan	96
Haji	Maaz	Identifying Predictors of Outcomes in Early Liver Transplantation for Alcohol Associated Hepatitis	Dr. Amanda Cheung, MD	60
Hanna	Sarra	Evaluation of Continuous Skin Surface Temperature Monitoring and Temperature Transition Point Determination in Hemodynamically Unstable Patients	Dr. Raul Gazmuri	67
Hill	John	Qualitative Analysis of Chicago CARES Lifestyle Coach Interviews	Dr. Jackie Jacobs	86
Holic	Lindsay	Skin cancers and their association with other non-cutaneous primary malignancies	Dr. Michael Gold	83
Hrnciar	Jessica	Chicago Gun Violence Research Collaborative: Exploration of Gun Violence Prevention Initiatives for the Roseland Community	Dr. Myles Castro	38
Hsu	Jing Yun	Copy Number Deletion involving NUS1 associated with Epilepsy, Tremor, and Intellectual Disability	Dr. Gholson Lyon	75
Hu	Wenting	Supplementing with Zinc Aids in Reducing Severe Malnutrition in Preterm Infants	Dr. Alexandra Wilson, MD	90
Ibrahim	Daniah	Synthetic Lethal Phenotype in S. cerevisiae Shows Therapeutic Potential for Cln3 Batten's Disease	Dr. David Mueller	105
Iglesias	Roberto	Cerebral Ischemic Pathologies: Level of Care Pathway & Treatment Strategies	Dr. Ricardo Senno MD, MS, FAAPM&R	46
Islam	Humaira	Models of Care for Mental Health Emergencies	Dr. Michael Fendrich, PhD	52
Jalili	Paneed	Enhancing Ankle Arthrodesis in Complex Cases: The Role of Vascularized Fibula Flaps	Dr. Samandar Arriyan Dowlatshahi	34

Chicago Medical School

<i>Last Name</i>	<i>First Name</i>	<i>Poster Title</i>	<i>Mentor's Name(s)</i>	<i>Poster #</i>
Jung	Veronica	Hyperactivity of Default Mode Network in Attention Deficit Hyperactivity Disorder (ADHD) and Creativity	Dr. Lin Lu	30
Kainrath	Alissa	Unequal Cities: Expanding on Racial Inequities in Health Outcomes to Infant Mortality	Dr. Nazia Saiyed	64
Karikaran	Arjuna	Cauda Equina Syndrome: A Review of Best Practices	Dr. Adisu Mesfin	56
Katamanin	Olivia	Psychological Interventions in the Treatment of Delusional Parasitosis: A Systematic Review	Dr. Mohammad Jafferany	27
Kaul	Aayush	Correlation Between PROMIS Physical Function and Legacy Physical Function PROMs in Patients Undergoing Lateral Lumbar Interbody Fusion	Dr. Kern Singh	114
Kelekar	Neil	Acute Stroke Among Patients with COVID-19: A Retrospective Review of Cases	Dr. Akinyemi Akintayo ; Dr. Mohammed Shilleh	88
Ko	Jungyun	Access to Maternity Care In Chicago- A Local Level Environmental Scan	Dr. Melissa Gutierrez-Kapheim and Dr. Maureen Benjamins	51
Kuang	Run	Comparison of refractive outcome using trifocal and extended depth of focus intraocular lenses in immediately sequential bilateral cataract surgery	Dr. Dagny Zhu	31
Kuang	Katherine	Correlation of Suicide Prevalence and Education Expenditure in American High Schools	Dr. Dennis Stevens	58
Kulka	Emilia	Racial Inequities on Maternal Morbidity: A Study on Anemia and Substance Use Disorder (SUD)	Rheiner Mbaezue MD, MPH, Fernanda Alvarado MD, Connie Moreland MD, MmSc, FACOG	37
Kwiat	Meg	Neurodegenerative Dementias: Level of Care Pathway & Treatment Strategies	Dr. Ricardo Senno	44
Leung	Anne	Unequal Cities: Expanding on Racial Inequities in Health Outcomes to Infant Mortality	Dr. Nazia Saiyed MPH	64
Liu	Jessica	The role of IL 27R signaling in NASH-HCC exploring the preclinical implications of IL-27 receptor signaling in non-alcoholic steatohepatitis (NASH) mouse models	Dr. Ekaterina Koltsova	76
Lo	Jonathan	Utilization of the ResNet18 Convolutional Neural Network for Computer Assisted Detection of Stress Fractures of the Ankle and Foot	Dr. Mark Conneely	80
Loyal	Vincent	Isolated and Resistant?: The Effects of Social Isolation on Insulin Response in CHO-IR Cells	Dr. Matthew Brady, PhD, UChicago	29
Madigan	Caroline	Increasing patient comfort during electromyography with the addition of a cooling spray	Dr. Bharathi Swaminathan	23
Makwana	Rikhil	Utilization of the ResNet18 Convolutional Neural Network for Computer Assisted Detection of Stress Fractures of the Ankle and Foot.	Dr. Mark Conneely	80
Malakismail	Jacob	Pharmacological Interventions to Mitigate Premature Aging in Patients with HIV	Dr. Roxane Rohani	63
Marzvaan	Cameron	A rare case of branchial cleft cyst incidentally found in an elderly man	Dr. Mahshid Mir	99
Megerdichian	Nareh	Pain, Physical function, and Emotional Distress: which is a better predictor for unemployment due to pain?	Dr. Sophia You, PhD	55
Mehta	Twinkle	Female Barriers to Enrollment in a Post-Stroke Neuromodulation & Walking Study	Dr. Sangeetha Madhavan PT, PhD	107
Mendez	Nicholas	Using Musical Feedback to Retrain Gait in Patients with Osteoarthritis	Dr. Markus Wimmer, Dr. Luisa Cedin	71
Metcalf	Bailey	Is an Expressive Writing Exercise Useful for Reducing Stress of Teenagers in a School Setting?	Dr. David Thoele, Dr. Marjorie Getz	108
Mody	Juhi	Cognitive training to enhance cognitive reserve across the lifespan in AD mice	Dr. Holly Hunsberger	103
Morehead	Evlyn	Prenatal Cannabis Exposure and Early Language Development	Dr. Maria Barber, Dr. Amy Elliott, Dr. Christine Hockett	91

Chicago Medical School

<i>Last Name</i>	<i>First Name</i>	<i>Poster Title</i>	<i>Mentor's Name(s)</i>	<i>Poster #</i>
Naumann	Lilly	Racial Inequities on Maternal Morbidity: A Study on Anemia and Substance Use Disorder (SUD)	Rheiner Mbaezue MD, MPH, Fernanda Alvarado MD, Connie Moreland MD, MmSc, FACOG	37
Nederveld	Tovey	Education and Interventions to Address Safe Sleep Disparities	Dr. Amy Elliott	73
Nguyen	Kristina	Impact of State-level Health Insurance Benefit Mandates on Fertility Preservation Access and Affordability	Dr. Irene Su	61
Niedermair	Isabella	OBGYN Unveiled: The Truth About PCOS on Social Media and the Current State of Residency Programs	Dr. Callie Cox Bauer, DO	40
Obot	Sefonobong	Live Well Lake County Access to Care Team: Development of a Health Literacy Community Conversation Guide	Dr. Yvette Castañeda	85
Oh	Ju	Utilization of the ResNet18 Convolutional Neural Network for Computer Assisted Detection of Stress Fractures of the Ankle and Foot.	Dr. Mark Conneely, MD	80
Ong	Briana	Community Health Worker (CHW) Training Models & Evaluations	Patricia Labellarte MPH	72
Osak	Phillip	Evaluation of Continuous Skin Surface Temperature Monitoring and Temperature Transition Point Determination in Hemodynamically Unstable Patients	Dr. Raul Gazmuri	67
Park	So Hyeon	Associations Between Weight Status and Patient Outcomes in the Pediatric Intensive Care Unit	Dr. Vinod Havalad, MD	50
Patel	Rahi	Ophthalmic Manifestations of NAA10 and NAA15 Mutations	Dr. Gholson Lyon	41
Patel	Harsh	Neck Circumference and Its Impact on Upper Airway Collapsibility	Dr. Michael Hutz	111
Paudel	Manasvi	Examining the Role of GERD Quality of Life Scores in Predicting Hiatal Hernia Recurrence	Dr. Charudutt Paranjape	57
Peek	George	Robotic Assisted Transhiatal Esophagectomy and Artificial Intelligence	Dr. Sharona Ross	110
Pelletier	Martin	The use of ketamine for prehospital sedative-assisted intubation	Dr. Nathan Sandalow	54
Perez	Aldo	Measuring Structural Racism: a literature review on the nuances behind quantifying social forces	Dr. Jessica Bishop-Royse, Dr. Melissa Gutierrez-Kapheim	32
Pham	Josephine	Effects of pEC-specific knockout of HIF-1 α and HIF-2 α subunits on pulmonary physiology and asthma pathogenesis observed in OVA-induced murine model	Dr. Laura Crotty Alexander	106
Pinkerton	Jack	Lipoxin Treatment of Kaposi Sarcoma Herpesvirus-Related Primary Effusion Lymphoma	Dr. Neelam Sharma-Walia	65
Rabelas	Juvy	Addressing the Indigenous Infant Mortality Crisis in South Dakota	Dr. Amy Elliott	101
Sartori	Amanda	Gliflozins in Cardiac Resuscitation	Dr. Raul Gazmuri	92
Schaffer	Sabina	Is Magnetic Resonance Imaging Overutilized Among Patients Undergoing Total Knee Arthroplasty?	Dr. Julie McCauley, Dr. Jeffrey Wilde	62
Sedaghat	Brandon	ASSOCIATION OF NEIGHBORHOOD-LEVEL SOCIAL DETERMINANTS OF HEALTH AND LOSS OF GLYCEMIC CONTROL DURING THE COVID-19 PANDEMIC	Dr. Joseph E. Ebinger, MD	84
Serota	Raina	Association Between Perioperative Benzodiazepine Use and Postoperative Delirium in Frail Older Adults: Does Home Use Influence Outcomes?	Dr. Cecilia Canales	94
Shrestha	Nancy	Treatment of Anterior Cruciate Ligament Injuries: ChatGPT Models vs. AAOS Appropriate Use Criteria Ratings	Dr. Samuel K. Cho	109
Smith	Martha	Exercise as Treatment for NAFLD in Children	Dr. Jeffrey Schwimmer	49

Chicago Medical School

<i>Last Name</i>	<i>First Name</i>	<i>Poster Title</i>	<i>Mentor's Name(s)</i>	<i>Poster #</i>
Suresh	Siddharth	Transcatheter Aortic Valve Replacement: Outcomes in Discordant Versus Concordant Severe Aortic Stenosis Patients	Dr. Muhammad Jan	35
Syed	Sarah	Community Health Worker (CHW) Training Models & Evaluations	Patricia Labellarte, MPH	72
Taiberg	Stephanie	BIOCHEMICAL ANALYSIS OF BURR HOLD INTEGRATION FOR PREVENTING INTRAOPERATIVE FRACTURES IN CRANIOSYNOSTOSIS SURGERY	Dr. Lee Alkureishi, MD	69
Talebi	Kayla	Live Well Lake County Access to Care Team: Development of a Health Literacy Community Conversation Guide	Dr. Yvette Castaneda	85
Thomas	Steffy	Burden of Comorbidities in Hidradenitis Suppurativa: A Real World Study	Dr. Beatrice Nardone	78
Tiba	Sarah	Live Well Lake County Access to Care Team: Development of a Health Literacy Community Conversation Guide	Dr. Yvette Castañeda and Dr. Amanda Simanek	85
Tsao	Tommi	Measuring Structural Racism: a literature review on the nuances behind quantifying social forces	Dr. Jessica Bishop-Royse, Dr. Melissa Gutierrez-Kapheim	32
Turcotte	Victoria	The Hidden Cost of IVF Care: Medical Financial Hardship	Dr. Irene Su, Dr. Sally Romero	48
Tyagi	Anshul	Examining the Impact of Social Determinants of Health on Self-Efficacy for Symptom and Medication Management in Adolescents and Young Adult Cancer Survivors	Dr. Meghan McGrady	93
Ung	Nathaniel	Unmasking latent connections in severe stroke using a novel dynamic multi-muscle TMS protocol: A Case Report	Dr. Dylan Edwards	24
Vadner	Douglas	Chicago CARES Qualitative Analysis	Dr. Jackie Jacobs	86
Villa	Jordan	Microelectrode Development: Brain-Machine Interface	Dr. Claus-Peter Richter	82
Villasis	Nicolo Antonio	Long COVID disproportionately reported by disadvantaged individuals: a national survey of US working-age adults	Dr. Lucinda Leung	33
Wang	Douglas	Rapid gastric emptying as cause of gastrointestinal symptoms in dysautonomia in a post-covid patient	Dr. Rachel Welbel	87
Wang	Ryan	Development of Novel Magnetic Kyphoplasty Treatment in a Rodent Metastatic Prostate Cancer Model	Dr. Ankit Mehta	89
Warren	Sam	Synthetic Lethal Phenotype in <i>S. cerevisiae</i> shows Therapeutic Potential for CLN3 Batten Disease	Dr. David Mueller	105
Winters	Alexander	Utilization of the ResNet18 Convolutional Neural Network for Computer Assisted Detection of Stress Fractures of the Ankle and Foot	Dr. Mark Conneely	80
Wolf	Jacob	Predictors of Minimum Clinically Important Difference in Cervical Disc Replacement versus Anterior Cervical Discectomy and Fusion	Dr. Kern Singh	115
Woo	Brandon	Advancing Analysis Methods for Comparing Trending Ability of Cardiac Output Measurement Devices	Dr. Joseph Rinehart, MD	116
Yamaguchi	Naosuke	Self-Reported and Objective Respiratory Outcomes Among Young Adult E-Cigarette Users	Dr. Alayna Tackett	66
Yoon	Hyerin	Systematic Review of Atrial Fibrillation On Atrial Myopathy And Valvular Disease	Dr. Renuka Jain, Stacie Kroboth	100

Awards Photos from Last Year



Photos from Last Year



Photos from Last Year



Venue Map

RWCLC 2.060

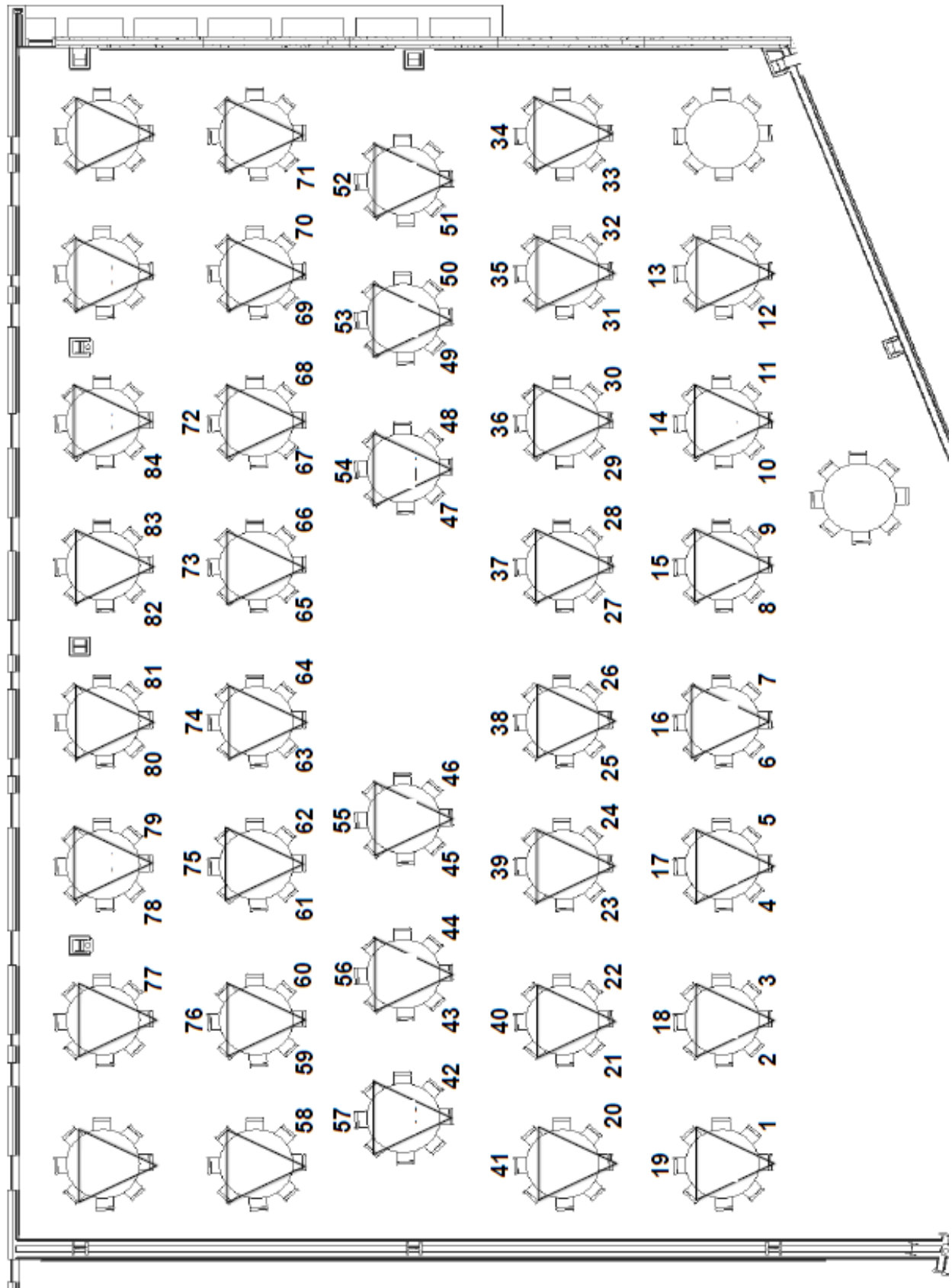

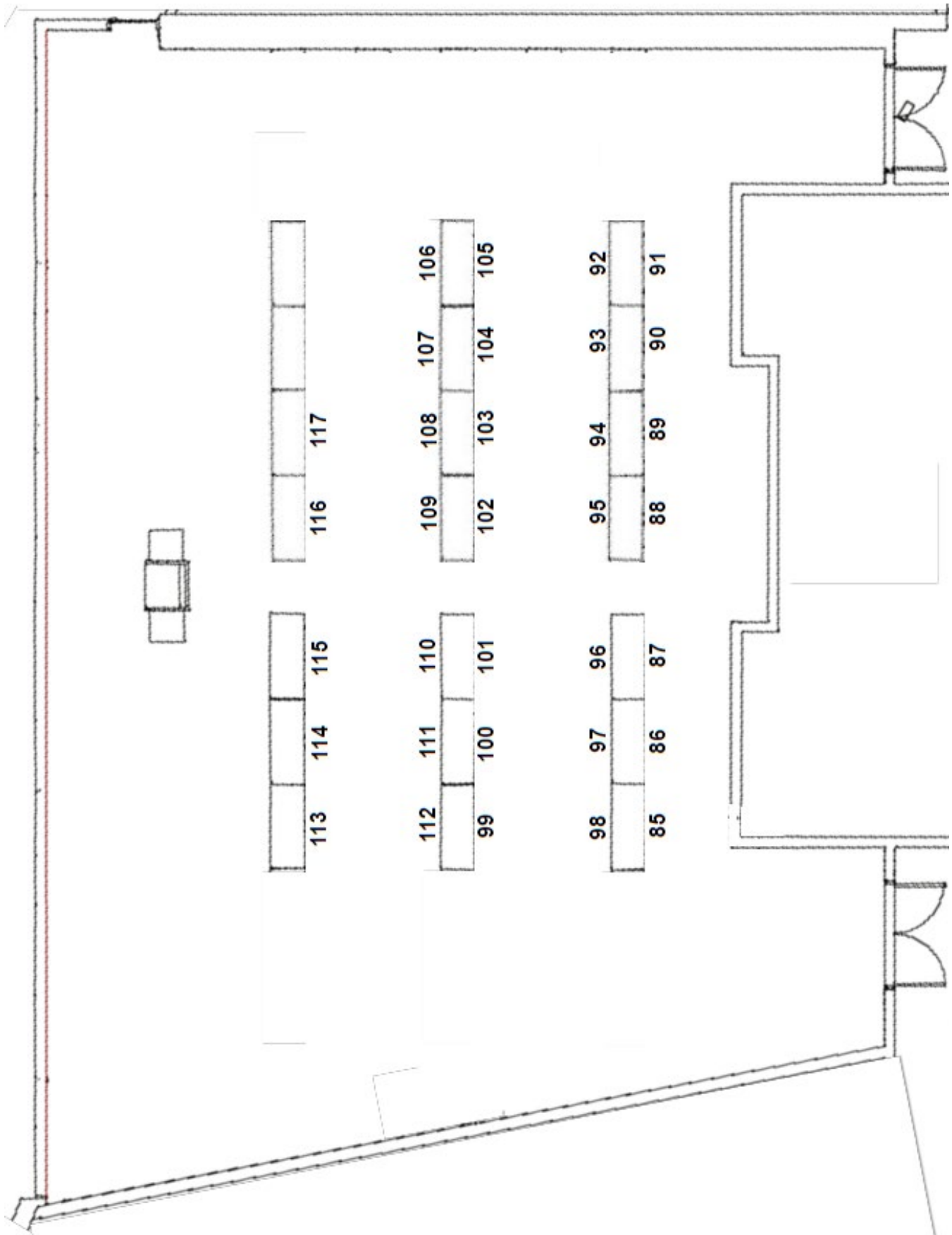

ROSALIND FRANKLIN UNIVERSITY *of* MEDICINE AND SCIENCE

